

Optical Telecommunication Outlet (OTO)

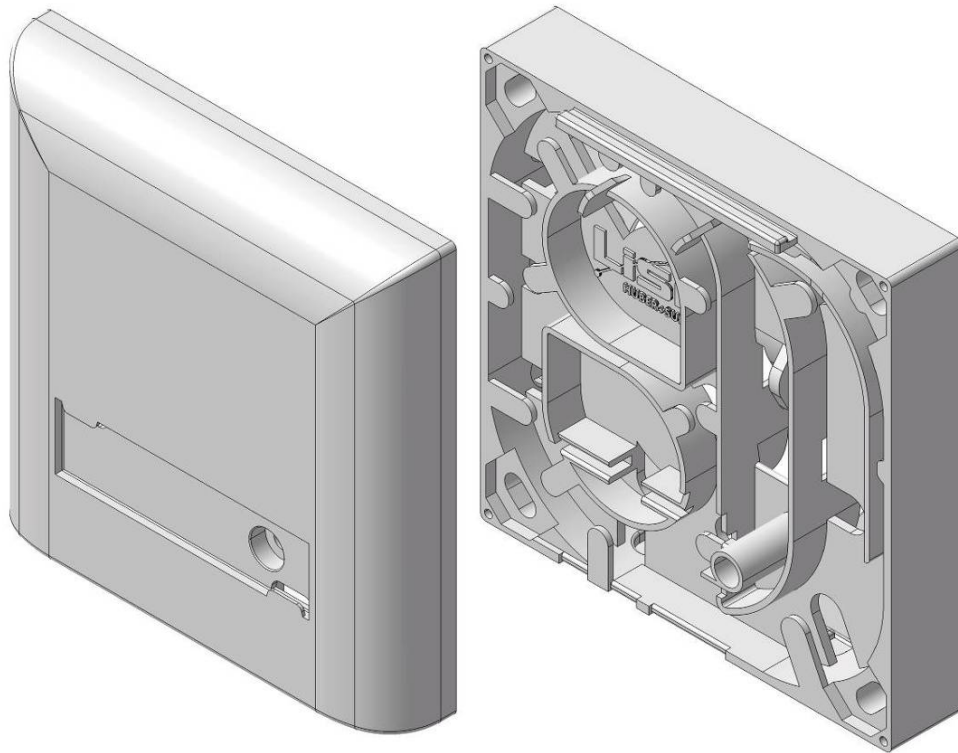

The OTO is an optical telecommunication outlet box, designed for low bend fibers and it is used to connect up to four optical fibers to the passive-optical interface in the living area (Fiber to The Home). Running as a flat surface mount, low profile and attractive timeless design it allows a smooth integration into existing connection areas. By having a fixation plate, surface installation as well as recessed mounting is practicable. Cable entry points are from each side of the OTO possible, which gives you a high flexibility by doing the in home installation. The internal fiber management allows an adequate fiber over length, whether for pig-tails splicing, FiTH preassembled cables or even for field termination connectors. Crimp splices (e.g. Fibrlok or RECORDsplice), shrink or sandwich splice protectors are kept safely into the corresponding holders.

The optical interface can be chosen between SC simplex or LC duplex. The adapters are equipped with a laser protection. The OTO also offers dust-proof caps for unused connector ports. The housing cover is fixed with a 'child-lock' screw and can be sealed. On the top cover is also a label option given.

Performance characteristics:

- Easy-to-install optical telecommunication outlet composed of an outlet body, cover, adapter panel and aluminium fixation plate
- Integrated fiber management for low-bend fibers acc. G.657 with a secondary coating of 600µm
- Supporting of up to 2 adapters with SC-shape (LC, SC, LX.5)
- Adapters, respectively connector interfaces are dust and laser protected
- Radius protected fiber over length management, min. bending radius of 15mm
- Up to 4 crimp- or fusion splices, storage of heatshrink or sandwich splice protection
- Moulded break out points for all side cable entry
- Serial switching of several outlets possible
- Screwed cover, screw can optional sealed
- Possibility of cover labelling
- Colour pure white



Optical Telecommunication Outlet (OTO)

Product overview:

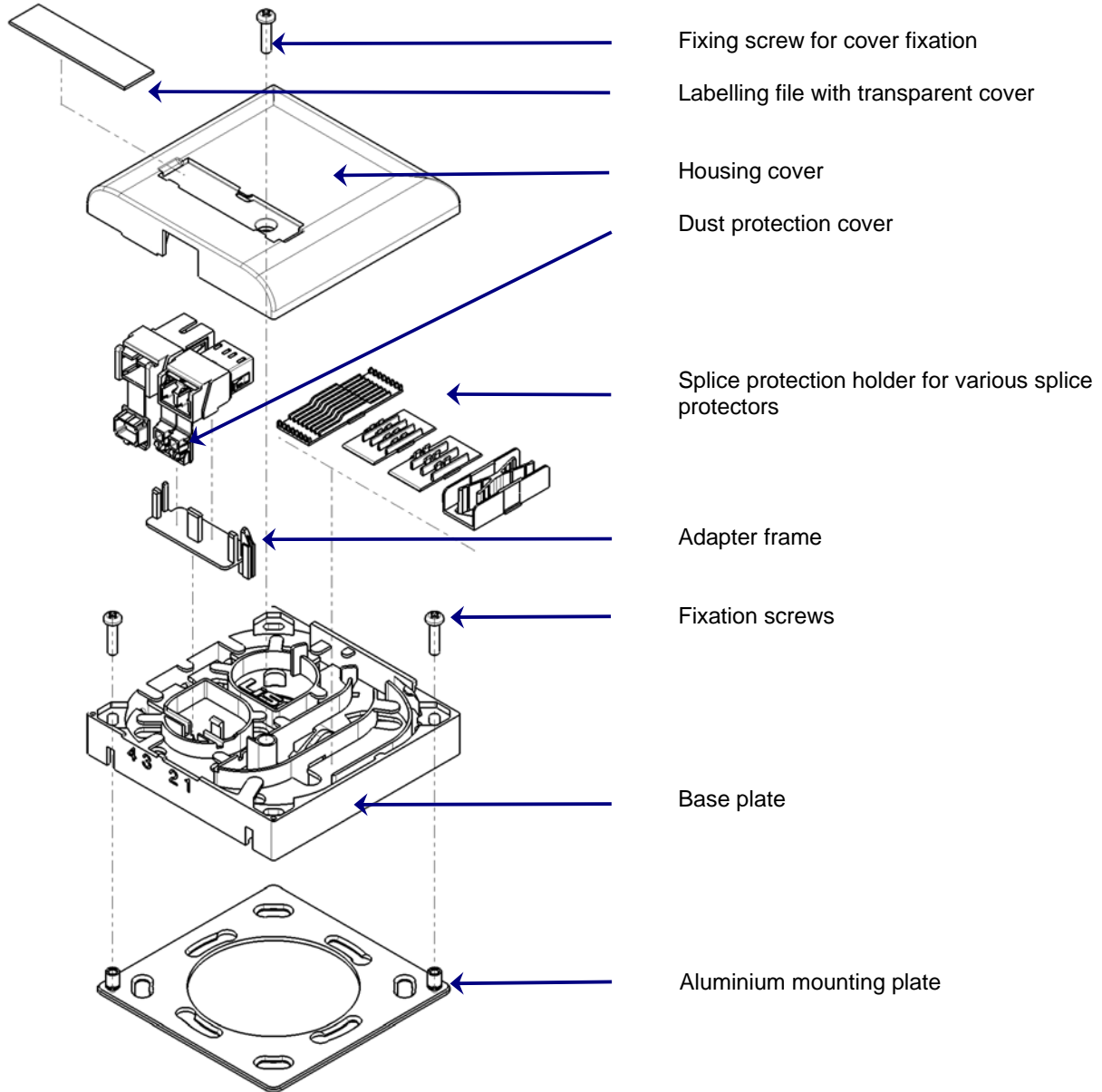



Optical Telecommunication Outlet (OTO)

- Front view - outlet base plate

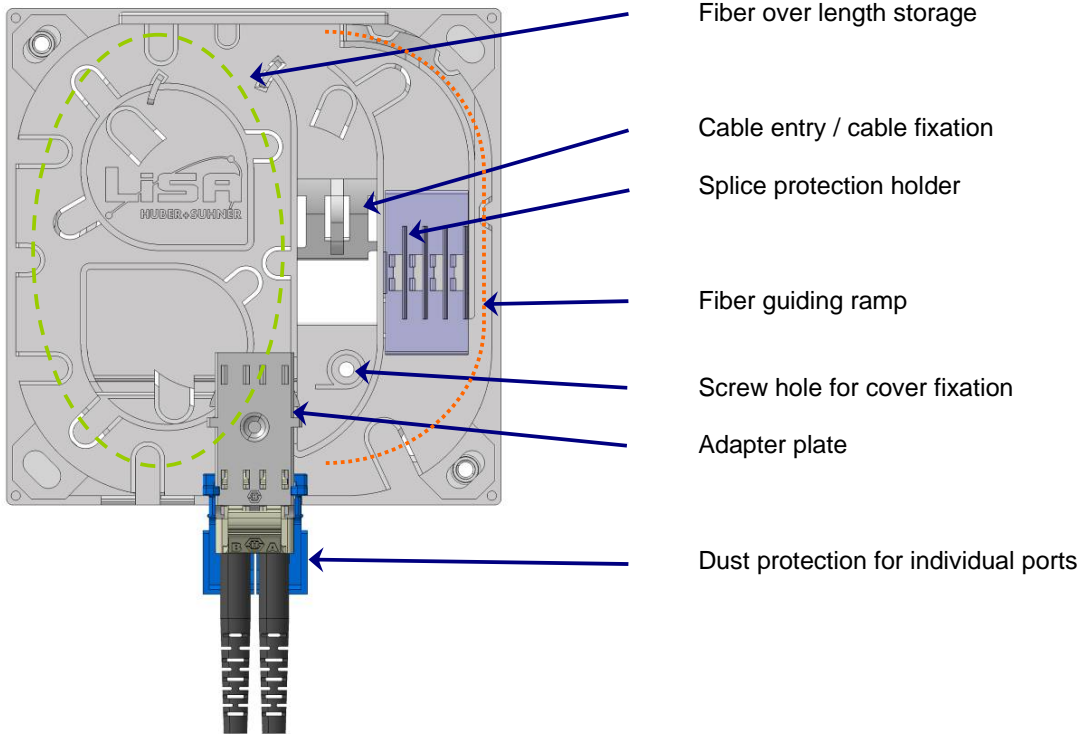

- Back view – outlet base plate

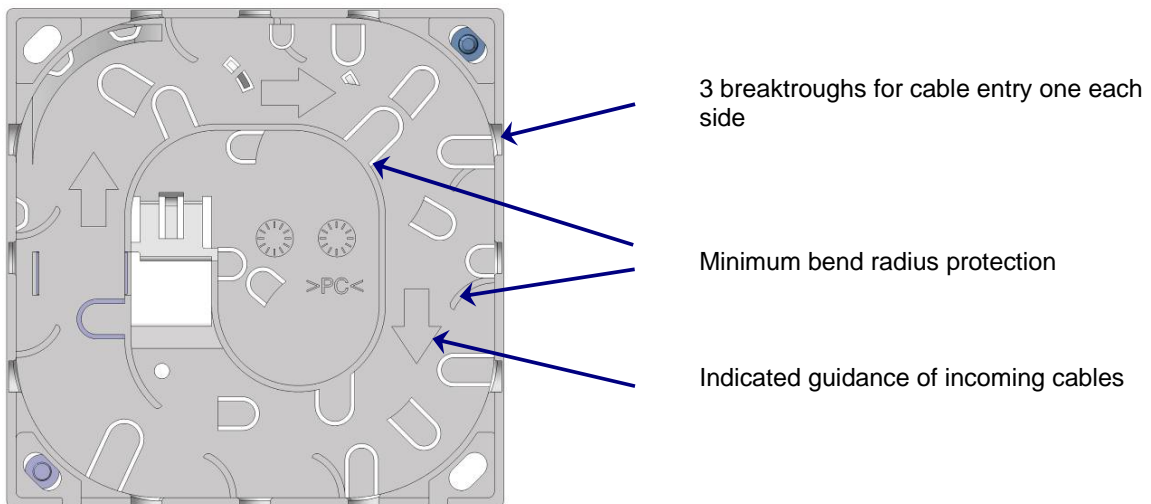



Optical Telecommunication Outlet (OTO)

Product overview:

- Front view - cover

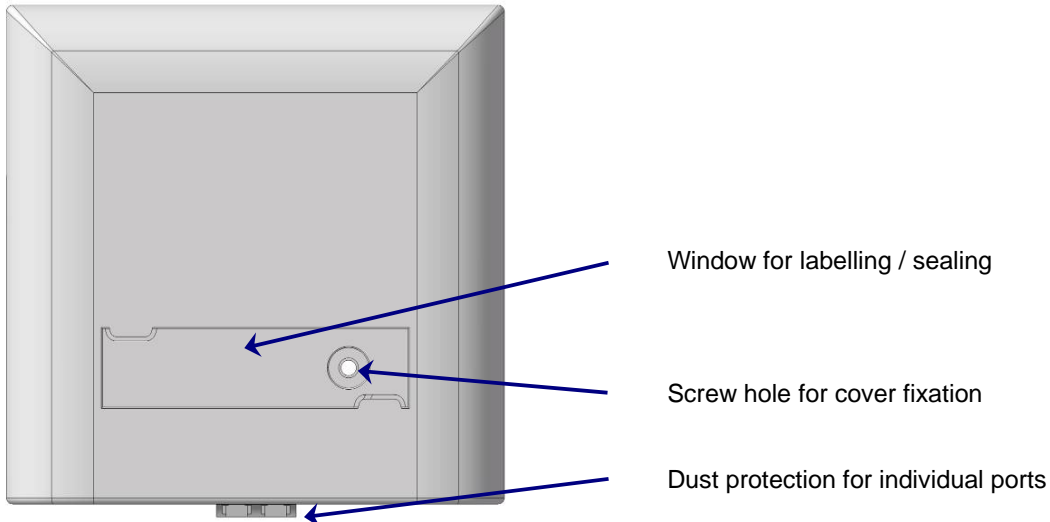

Technical Data:

Characteristics	Value
Dimension (W x L x D)	80 x 80 x 28mm
Capacity of optical Connectors	4x LC duplex or LX.5, 2x SC simplex
Mounting nature of Adapters	flange, snapped-in
Dimensions (Ø) of cable entry to break out	5.0mm
Minimum bending radius	14mm
Material: cover / base / adapter plate	Polycarbonate, PC
Mounting plate	Aluminium
Colour	RAL 9010, pure white
Degree of protection (EN60529)	IP20
Flammability rating	UL 94V-0
Free of halogen	yes
Chemical resistance	good
RoHS requirements	complied



Optical Telecommunication Outlet (OTO)

Technical Drawings:

Outlet body

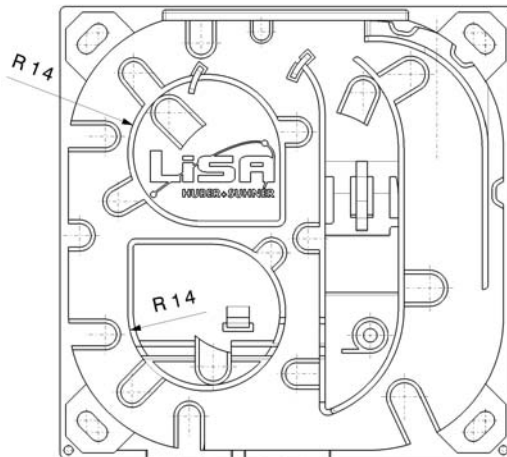

Mounting plate

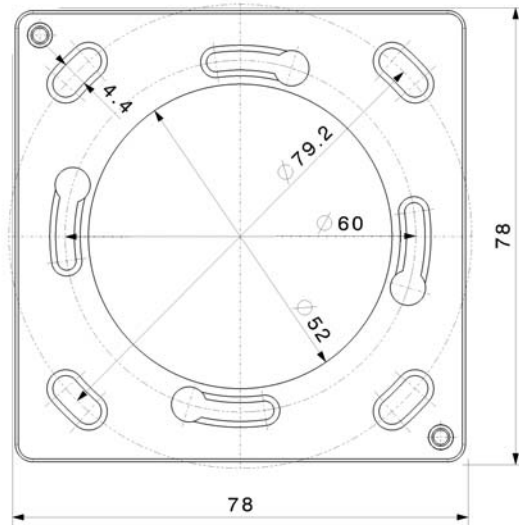

Cover

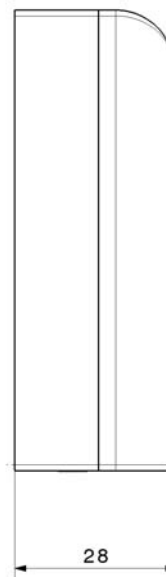
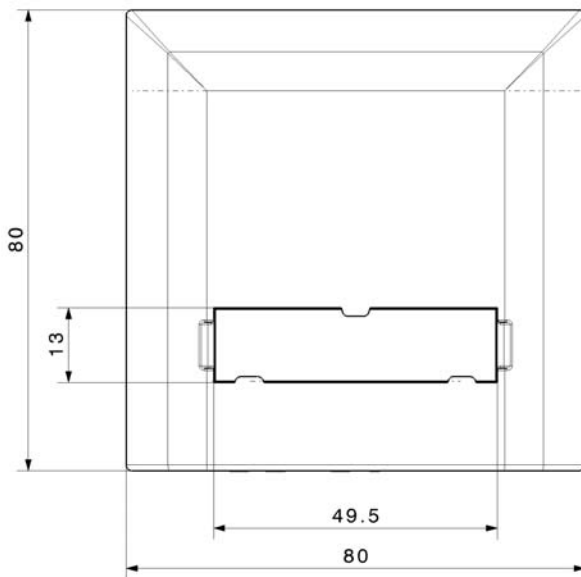

HUBER+SUHNER is certified according ISO 9001 and ISO 14001.



HUBER+SUHNER AG
Fiber Optics Division
9100 Herisau/Switzerland
Tel. +41 (71) 353 41 11
Fax +41 (71) 353 46 47
Email intouch@hubersuhner.com

Waver

It is exclusively in written agreements that we provide our customers with warrants and representations as to the technical specifications and/or the fitness for any particular purpose. The facts and figures contained herein are carefully compiled to the best of our knowledge, but there are intended for general information purpose only.